

Residential Two Piece Septic Tank

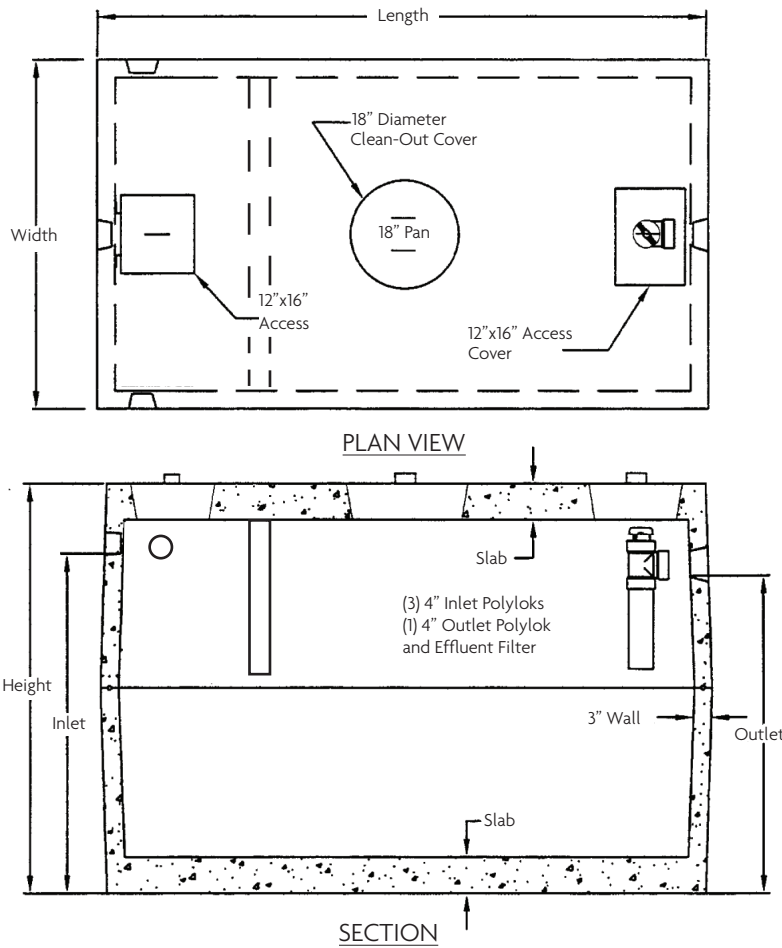

Capacity	Type	Length	Width	Height	Inlet	Outlet	Slab Botm/Top	Weight
1,000 Gal.	Reg/HD	8'-6"	4'-10"	5'-4"	4'-6"	4'-3"	4" / 5"	9,000 lbs.
1,000 Gal.	H-20	8'-6"	4'-10"	5'-8"	4'-8"	4'-5"	6" / 6"	10,000 lbs.
1,000 Gal.	Low Boy	10'-6"	6'-4"	4'-0"	3'-2"	2'-11"	4" / 5"	10,400 lbs.

Design Notes:

- 1) Regular and Heavy Duty Tanks are suitable for installation in NON-Traffic areas up to burial depths of 3 feet and 5 feet, respectively. H-20 tanks are suitable for Traffic areas up to burial depths of 5 feet.
- 2) Concrete Mix Design is 4,000 PSI standard at 28 days, Type 3 Cement for Regular and Heavy Duty, and 5,000PSI for H-20 tanks.
- 3) Reinforcing Steel ASTM A 615, Grade 60, places to an engineered design for the H-20 tanks.
- 4) The tongue and groove center seam sealed with butyl sealant.
- 5) All covers provided with pencil rod handles or lift loops.
- 6) The plastic baffles can be moved to any of the Inlets.
- 7) The covers on the outlet end of the tank are sized to accept an Effluent Filter.
- 8) POLYLOK PIPE SEALS standard at all pipe penetrations.